

R2600
A

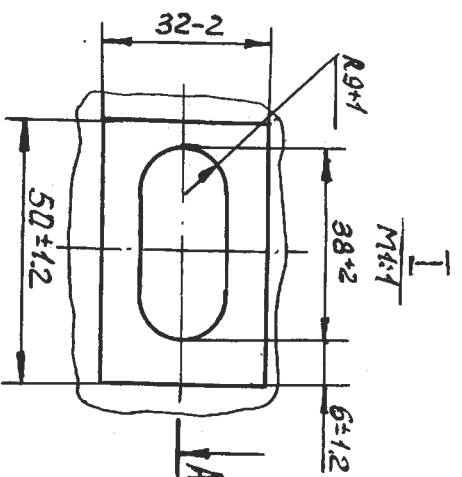

Technical drawing of a stepped shaft. The shaft has a total length of 26 ± 1.5. The diameter of the main shaft is 8 ± 1. The shaft has a central hole with a diameter of 8 ± 1. The shaft has a central hole with a diameter of 8 ± 1. The shaft has a central hole with a diameter of 8 ± 1.

- 6.154

[illegible]